

INSTALLATION INSTRUCTIONS

MARBLETREND FLINDERS SHOWER TIDY

JohnsonSuisse
Bathroom Solutions

Model code:

2 Shelf model	TIMEDEAC
3 Shelf model	TIMEDEAC3

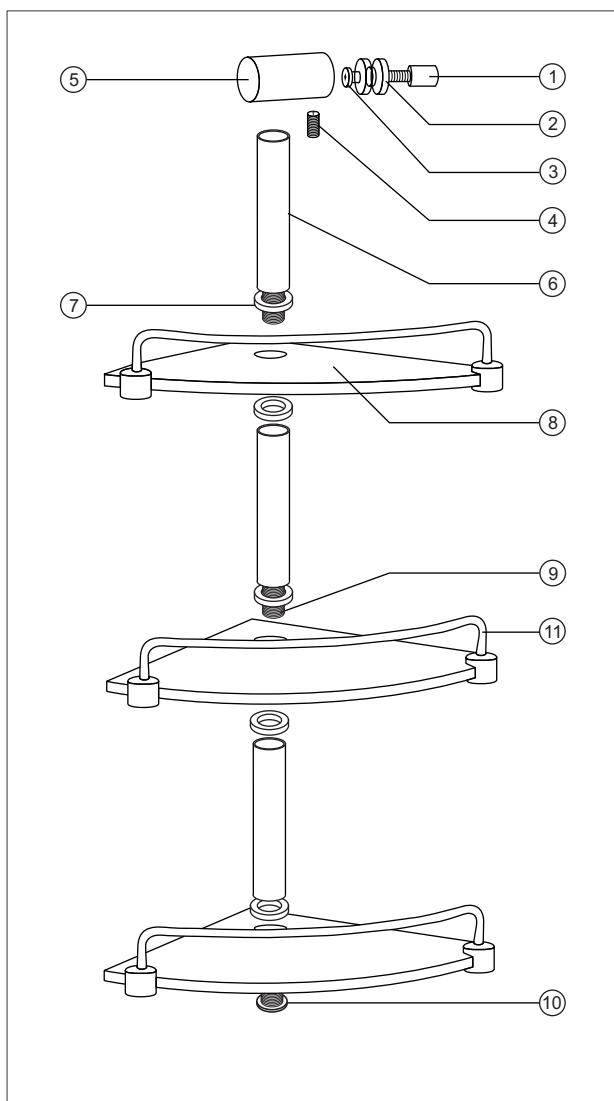

ASSEMBLY

1. Assemble the shower tidy shelves and fixing arm as shown in diagram
2. Locate the corner fixing point for the fixing arm and drill a 6mm hole in the wall lining and insert the wall plug
3. Fasten the fixing ring to the wall
4. Slide the fixing arm onto the fixing ring and secure with the set screw
5. The weight of items on the shelf must not exceed 1.5kg

PARTS LIST

1. Wall plug
2. Fixing ring
3. Screw (40mm)
4. Fixing arm set screw (2.5mm)
5. Fixing arm
6. Connecting rods (2 or 3)
7. Washers (3 or 5)
8. Glass shelves (2 or 3)
9. Connection bolt (1 or 2)
10. Bottom bolt
11. Guard rail (2 or 3)
12. 2.5mm Allen key

CLEANING

Occasional cleaning with a soft cloth and warm soapy water is all that is required to keep your Shower Tidy in good condition. Glass shelves can be cleaned with propriety glass cleaner. **Do not use harsh or abrasive cleaning agents.**



See warranty terms and conditions at:
www.johnsonssuisse.com.au



2 Shelf
535mmH



3 Shelf
770mmH

Bathroom Products Australia P/L
2/97 Banksia St
Botany, NSW 2019
Tel: 1300 717 717
www.johnsonssuisse.com.au