

IMPORTANT: Please read all of the instructions before installation.

General:

- Johnson Suisse recommends this product is installed by a licensed plumber in compliance with all relevant regional regulations and As3500.
- Do not conduct a hydrostatic test on the installation with this mixer installed. This may damage the ceramic cartridge.
- Prior to the installation of the mixer, all pipe work should be thoroughly flushed.
- To prevent foreign particles damaging the ceramic cartridge, in-line filters must be fitted on both hot and cold supplies.
- Do not remove the ceramic cartridge from the mixer when installing.
- After installation all connections must be checked for leaks.
- All outlets used primarily for personal hygiene shall deliver water at a safe temperature as per regional regulations.
- In case limited water flow is experienced, clean aerator and filter washers to remove any foreign material.
- The installer has the responsibility to ensure a waterproof seal between the product and mounting surface. If in doubt about the quality of the seal, remove the product and reinstall.

See full warranty terms and conditions at www.johnsonsuisse.com.au



CARE AND CLEANING:

Never use abrasives or abrasive cleaning agents to clean this product. Clean regularly with contamination free warm soapy water and a damp soft cloth.

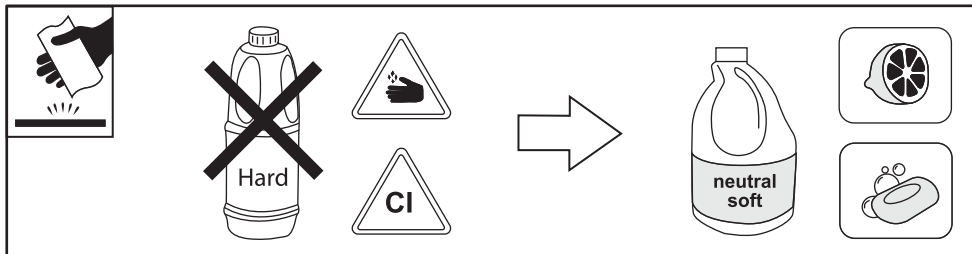

VENEZIA Sink Mixers Installation Guide

Technical Specifications:

Operating Pressure:

Min:150kPa/1.5bar

Max:500kPa/5bar*

Optimum: 150kPa/1.5bar - 500kPa/5bar

Operating Temperature:

Hot: Max 80°C (Regional specific regulations apply)

Cold: Min 5°C

Inlet Connections:

All 1/2" BSP

Model No:

JTV403XXX

JTV405XXX

JTV406XXX

XXX - defines
the finish colour

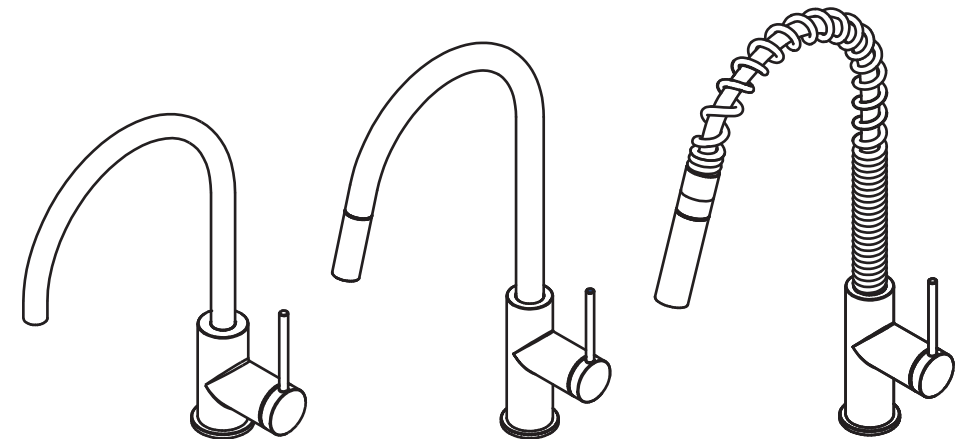

GOOSENECK
SINK MIXER
JTV403

GOOSENECKPULL-OUT
SINK MIXER
JTV405

GOOSENECK PULL-OUT
SPRING SINK MIXER
JTV406

IMPORTANT: Please read all of the instructions before installation.

DIAGRAM

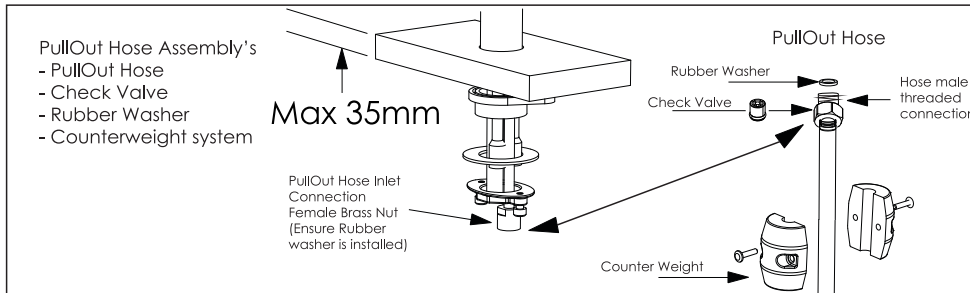
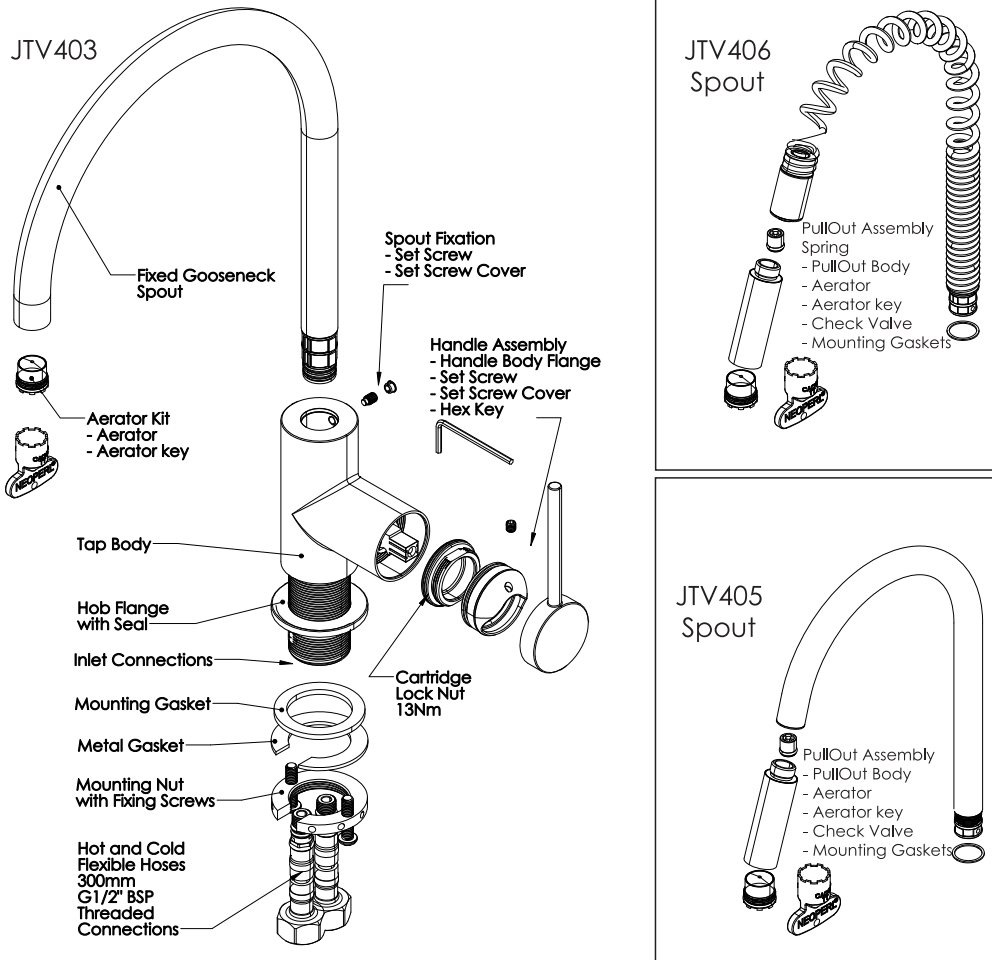

IMPORTANT: Before you begin, turn off the water supply. It is recommended to fit isolation valves both the hot and cold supply.

INSTALLATION PROCEDURE:

1. Ensure hole size in mounting surface is between 35mm and 40mm in diameter. Bench mounting thickness must be less than or equal to 35mm.
2. Take the hob flange with seal slide over inlet tubes and hoses on the mixer.
3. Guide all connected hoses through the hole from the top of the mounting surface and locate hob flange correctly around hole.
4. Slide the mounting gasket and metal gasket and mounting nut with fixing screws over tubes and hoses and screw locking nut onto thread base tube. Ensure mixer is in the desired position with the hob flange and seal completely covering the hole (use silicone sealant if necessary to ensure a water-tight seal). Hand-tighten the locking ring up to the underside of the mounting surface. Once hand tight use a screwdriver to tighten the locking screws against the metal gasket.
5. From beneath the bench thread the male ends of the flexible hoses up into the brass inlet connections - Hand tighten only.
 1. For PullOut Style Mixers - Fit the rubber washer supplied into the longer hose tail and connect pull-out hose. Carefully tighten with spanners to ensure a seal.
 2. Position the two halves of the counter-weight around the pull-out hose on the inlet side of the hose before the hose starts to loop. Tighten the screws to lock it in place. Make sure the counter weight is not obstructed by objects or shelves under the bench, the weight should hang freely.
6. Ensure filter washers are in place in the ends of the flexible supply hoses.
7. Flush the hot and cold supply pipes to remove any debris.
8. Stop valves must be fitted to the supply pipework to permit isolation.
9. Attach the 1/2" BSP female flexible hose connections to their respective hot and cold supply stop valves - do not over tighten and avoid kinks and sharp bends in the hose.
10. Turn on the water supply and check carefully for leaks. Re-tighten joints if necessary.

